



VERIFICA TECNICA DELLA VULNERABILITA'
SISMICA DELLA SCUOLA ELEMENTARE
"MONTESSORI" DI CASTELFIDARDO

PIANTA FONDAZIONI E PARTICOLARI
-STATO DI FATTO-

COMMITTENTE: Comune di CastelFidardo

PROGETTISTA: Ing. Alessandro Bianchi

COLLABORAZIONE: Ing. Silvia Tassi Ing. Chiara Pesaresi

REV.	DATA	MOTIVO	SCALA	TAVOLA
00	Giugno 2018		1:50	D2

Cemento tipo 730
Sfalzo H=16÷4; H=20÷4 l=33 cm
Ripartizione Ø8/25 cm

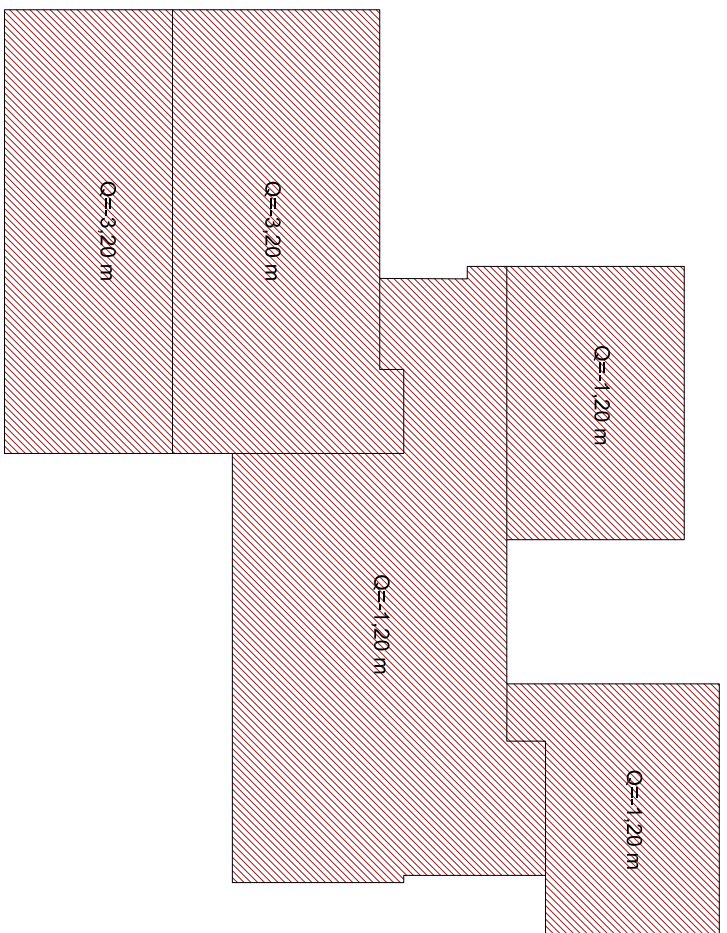
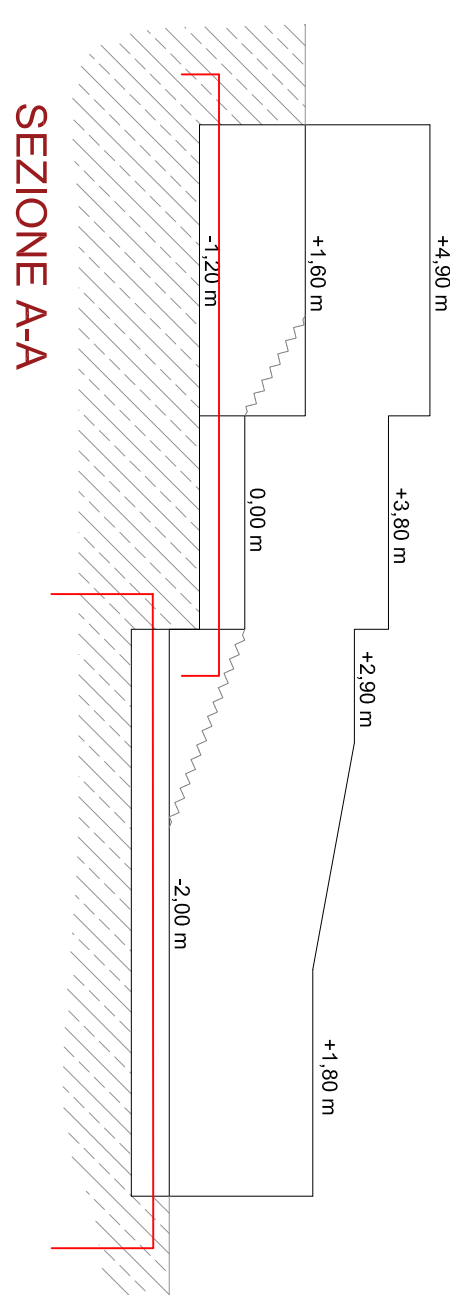

Pianta delle fondazioni

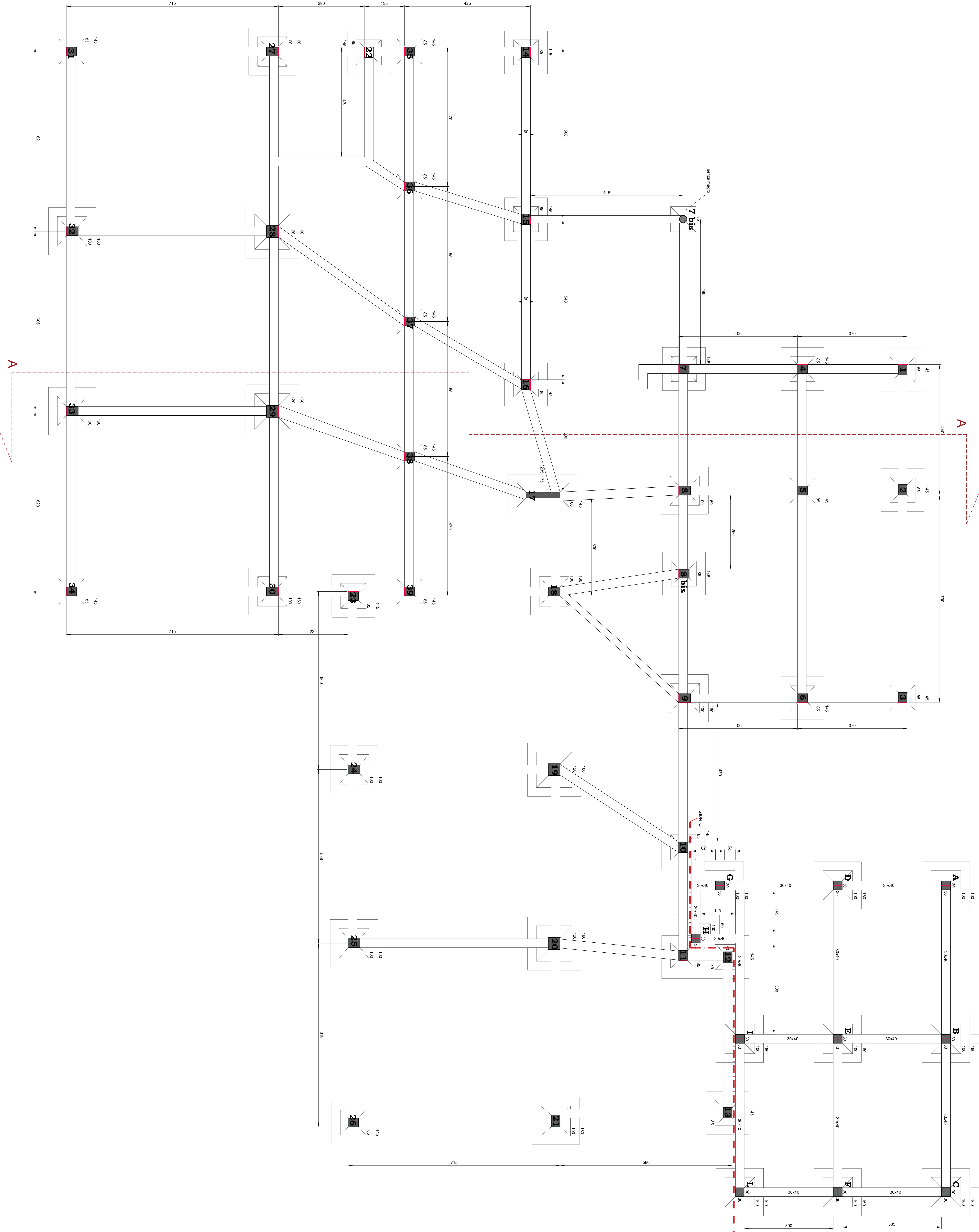

Pianti 85x85 cm

Scala 1:25

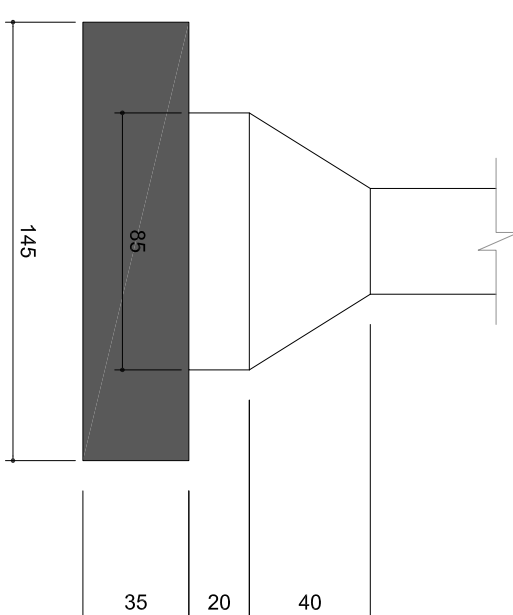

Pianti 100x100 cm

Scala 1:25

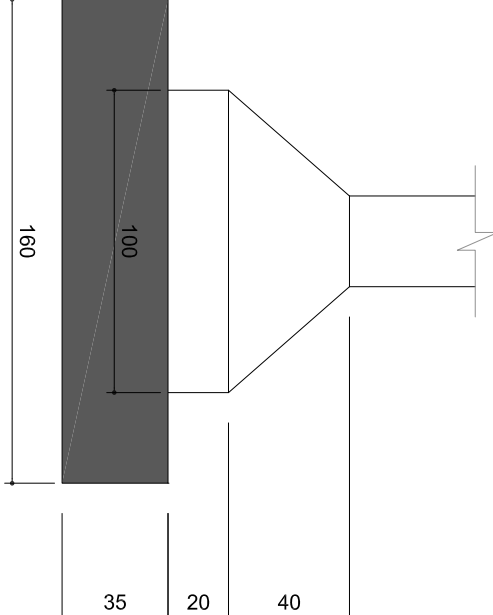

Pianti 120x120 cm

Scala 1:25

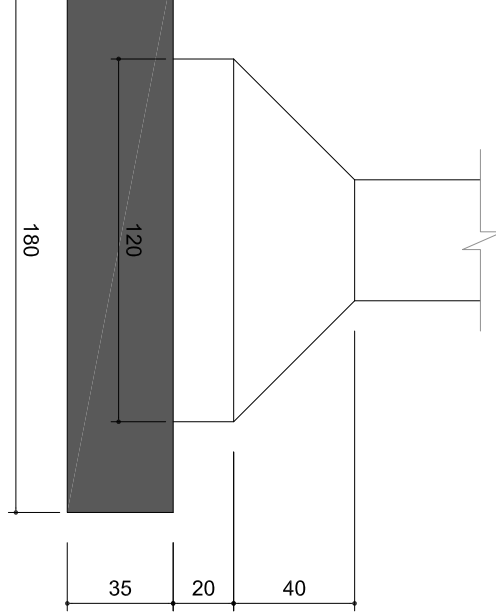

Cordoli di fondazione 30x30 cm

Scala 1:25

